

CATALOG NUMBER	182755	
CAP TYPE	PLUG SEAL	
PACKAGING	20 BOTTLES PER BAG/20 BOTTLES PER BOX	
DOUBLE BAG	YES	
GROWTH SURFACE AREA	850cm²	
BOTTLE MATERIAL	CRYSTAL POLYSTYRENE	
CLOSURE MATERIAL	HDPE	
NOMINAL CAPACITY	2000mL	
CLOSURE SIZE (mm)	48	
	INCH	MM
A (CLOSURE DIAMETER)	2.07	52.6
B (HEIGHT TO SHOULDER)	9.05	229.9
C (HEIGHT W/CLOSURE)	10.9	276.9
D (DIAMETER)	4.62	117.3
E (WALL THICKNESS)	.023	.58

1. ALL DIMENSIONS ARE NOMINAL AND IN INCHES AND MILLIMETERS UNLESS OTHERWISE NOTED.
2. THIS IS NOT A PRODUCTION DRAWING, BUT IS FOR INFORMATIONAL PURPOSES ONLY, AND IS SUBJECT TO CHANGE WITHOUT NOTICE.

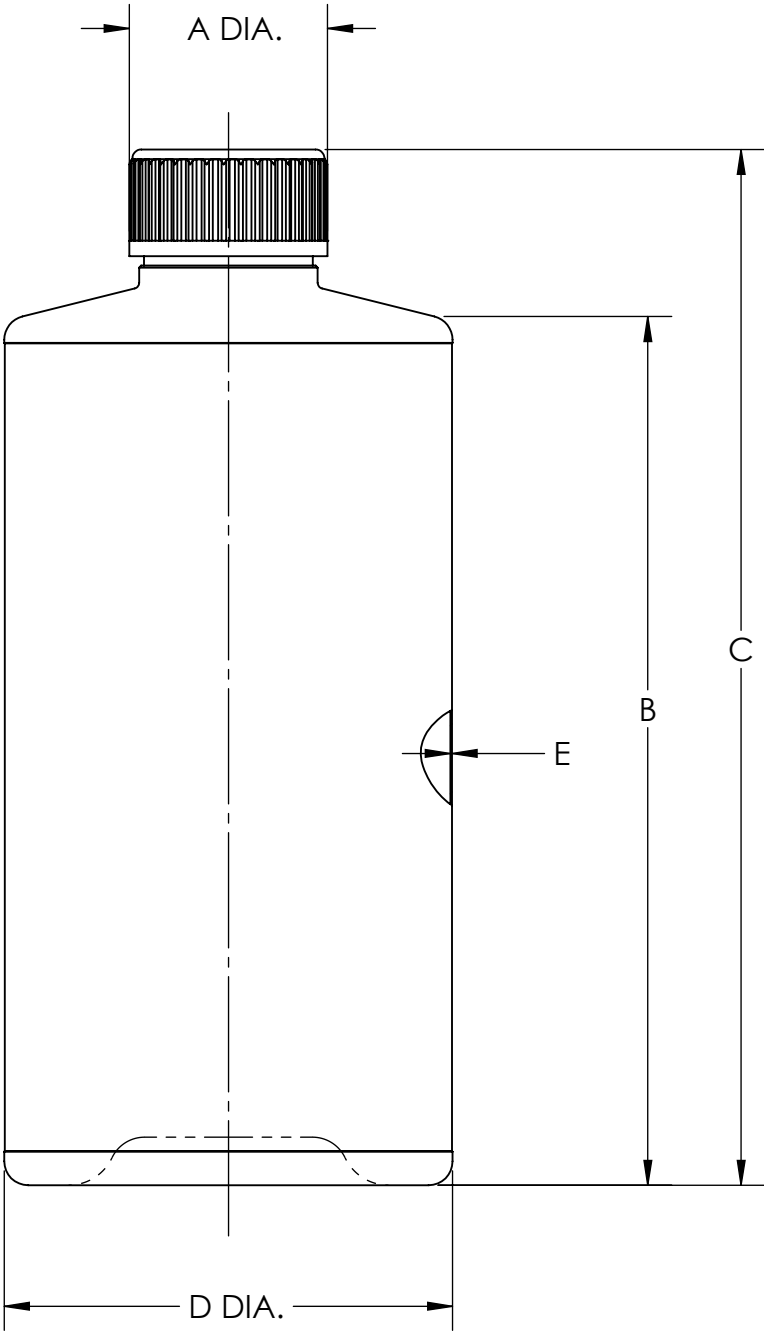

SPECS ON BACK

NOT TO SCALE

CONFIDENTIAL

THIS PRODUCT SPECIFICATION SHEET CONTAINS CONFIDENTIAL AND/OR PROPRIETARY INFORMATION AND IS TO BE USED ONLY FOR THE EXPRESSED PURPOSES AGREED UPON BY AN AUTHORIZED OFFICER OF THERMO FISHER SCIENTIFIC.

ThermoFisher
SCIENTIFIC

Thermo Fisher Scientific
75 Panorama Creek Drive
Rochester, NY 14625-2385, USA

MADE P. PELYCHATY		APP'D 5/27/16	PSS 182755	REV. 0316
CK'D JC		PWC		
DESCRIPTION: ROLLER BOTTLE, 850 cm ² - NO LOGO				