

CATALOG NUMBER	CAP TYPE	PACKAGING	DOUBLE BAG
183902	EZ TWIST, VENTED	2 BTL'S PER BAG / 20 BTL'S PER BOX	NO
184902	EZ TWIST	2 BTL'S PER BAG / 20 BTL'S PER BOX	NO
184920	EZ TWIST	20 BTL'S PER BAG / 20 BTL'S PER BOX	NO
184944	EZ TWIST	20 BTL'S PER BAG / 20 BTL'S PER BOX	YES

GROWTH SURFACE AREA IN cm <sup>2</sup> .....:	850	
BOTTLE MATERIAL.....:	CRYSTAL POLYSTYRENE	
CLOSURE MATERIAL.....:	HDPE	
NOM. CAP.....:	2000mL	
CLOSURE SIZE (mm).....:	48	
	INCH	MM
A (CLOSURE O.D.).....:	2.07	52.5
B (HT. TO SHOULDER).....:	9.05	229.8
C (HT. W/ CLOSURE).....:	10.9	276.9
D (DIA.).....:	4.62	117.3
E (INDENT DEPTH).....:	1.00	25.4
W.T. (NOM. WALL THK.)..:	.023	.58

1. ALL DIMENSIONS ARE NOMINAL AND IN INCHES AND MILLIMETERS UNLESS OTHERWISE NOTED.
2. THIS IS NOT A PRODUCTION DRAWING, BUT IS FOR INFORMATIONAL PURPOSES ONLY, AND IS SUBJECT TO CHANGE WITHOUT NOTICE.

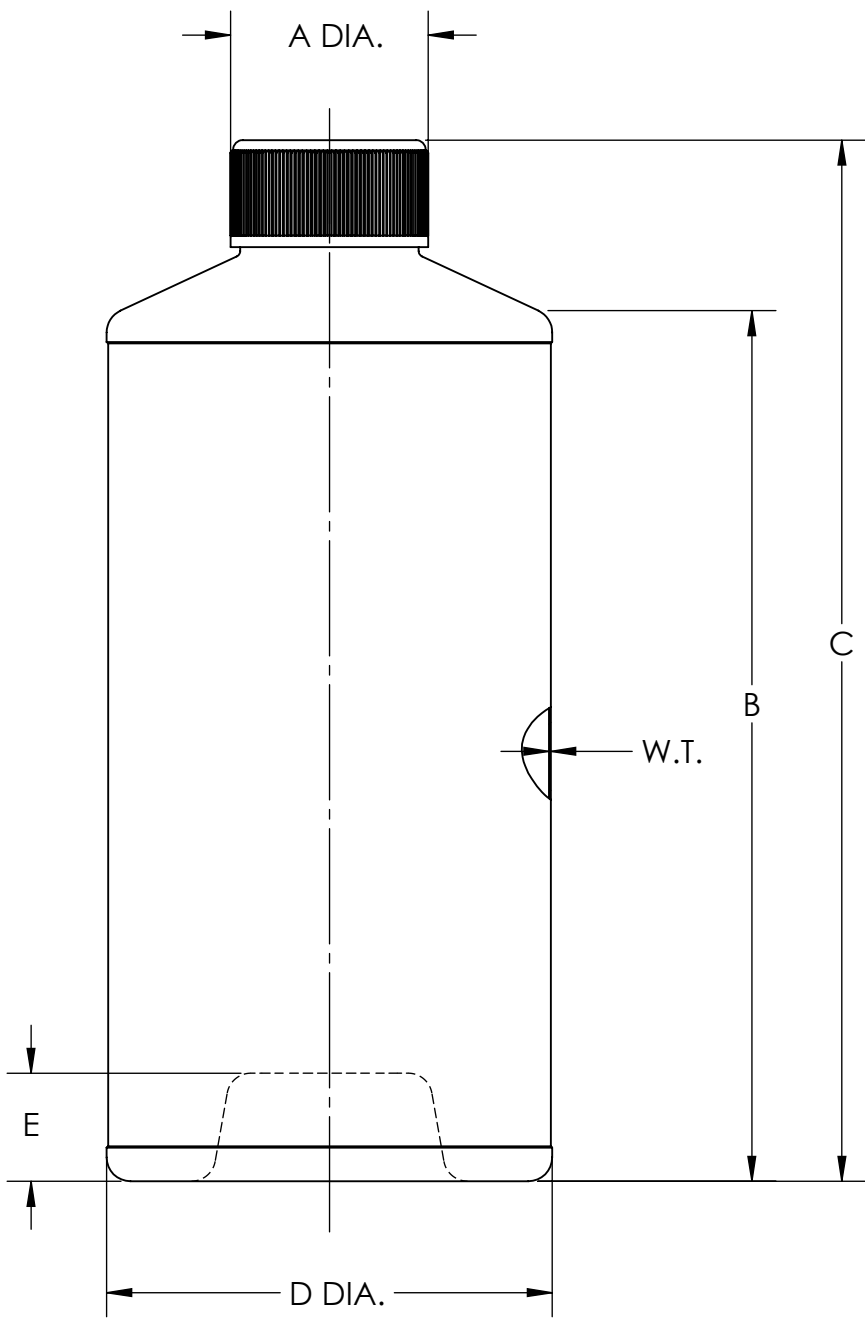

SPECS ON BACK

NOT TO SCALE

CONFIDENTIAL

THIS PRODUCT SPECIFICATION SHEET CONTAINS CONFIDENTIAL AND/OR PROPRIETARY INFORMATION AND IS TO BE USED ONLY FOR THE EXPRESSED PURPOSES AGREED UPON BY AN AUTHORIZED OFFICER OF THERMO FISHER SCIENTIFIC.

ThermoFisher  
SCIENTIFIC

Thermo Fisher Scientific  
75 Panorama Creek Drive  
Rochester, NY 14625-2385, USA

MADE	TL	APP'D	BR	PSS 18X9XX	REV. 0711
CK'D	PB	8/1/11			
DESCRIPTION: Nunc TufRol EZ Roller Bottles with deep indent					