

CATALOG NO.	NOMINAL CAPACITY, (mL/oz)		MATERIAL
	1000/32	3000/96	
001220	1000/32	3000/96	HDPE

SIZE CODE.....	-1250		-2500	
SIZE (NOM VOL mL/oz)	1000/32		3000/96	
NOM. WEIGHT (gms)...	215		350	
	IN	MM	IN	MM
A .....	6.4	162	9.0	228
B (DIA).....	3.8	97	6.2	158
H .....	7.2	183	7.6	193

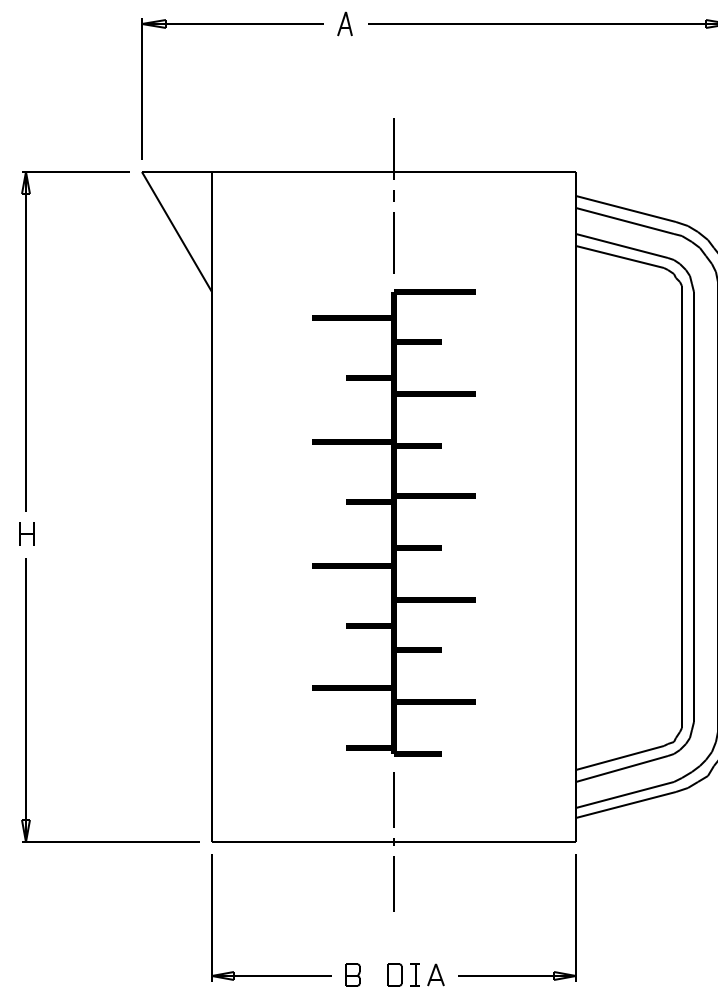

NOT TO SCALE

SPECS ON BACK

NOT TO SCALE

NOTES:

1. ALL DIMENSIONS ARE NOMINAL AND IN INCHES AND MILLIMETERS UNLESS OTHERWISE NOTED.
2. THIS IS NOT A PRODUCTION DRAWING, BUT IS FOR INFORMATIONAL PURPOSES ONLY, AND IS SUBJECT TO CHANGE WITHOUT NOTICE.

CONFIDENTIAL

THIS PRODUCT SPECIFICATION SHEET CONTAINS CONFIDENTIAL AND/OR PROPRIETARY INFORMATION AND IS TO BE USED ONLY FOR THE EXPRESSED PURPOSES AGREED UPON BY AN AUTHORIZED OFFICER OF THERMO FISHER SCIENTIFIC.

**ThermoFisher**  
SCIENTIFIC

Thermo Fisher Scientific  
75 Panorama Creek Drive  
Rochester, NY 14625-2385, USA

MADE	NS	APP'D	PVC	PSS 00-1220-XXXX-1	REV.	—
CK'D	PVC		2/13/91			
DESCRIPTION: GRADUATED BEAKERS WITH HANDLE						