

# SmartNotes

QA

## How does Auto-Lock Rotor Exchange facilitate rotor placement and improve safety, compared with traditional rotor tie-down systems?

In only 3 seconds, with just the push of a button, Thermo Scientific™ Auto-Lock™ Rotor Exchange allows you to install and remove rotors on select<sup>1</sup> Thermo Scientific superspeed, general purpose or small benchtop centrifuges. With Auto-Lock Rotor Exchange, you can have the confidence that your rotor is safely and securely locked in place, and have the flexibility to change rotors and applications in the blink of an eye.

Unlike traditional rotor tie-down systems, with push-button Auto-Lock Rotor Exchange, rotors no longer need to be bolted onto a centrifuge motor shaft. As a result:

1. No tools are required
2. No complicated rotor changing procedure is necessary
3. Swap between protocols instantly for application flexibility
4. Clear chamber access in only seconds for quick and efficient cleaning



Auto-Lock is identified on Thermo Scientific superspeed centrifuges with a **black push button** and on Thermo Scientific general purpose and small benchtop centrifuges with a **green push button**.

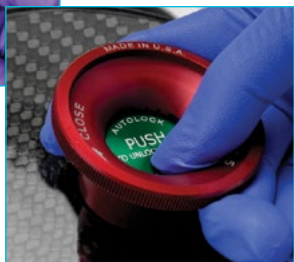

### <sup>1</sup> Auto-Lock is available with the following Thermo Scientific centrifuge series:

Superspeed	General Purpose	Small Benchtop
Sorvall™ LYNX 6000/4000	Sorvall™ Legend™ X1/XT/XF	Sorvall™ ST 8
	Sorvall™ ST 16/40	Megafuge™ 8
	Sorvall X4 Pro/ X4F Pro/ X1 Pro/ ST4 Plus, ST4F Plus and ST1 Plus	SL 8
	Multifuge™ X4 Pro/ X4F Pro/ X1 Pro/ Megafuge ST4 Plus, ST4F Plus and ST1 Plus	
	SL 16/40	
	SL4 F Plus	

Rotors featuring Auto-Lock are not interchangeable between platforms.

**Traditional rotor placement**

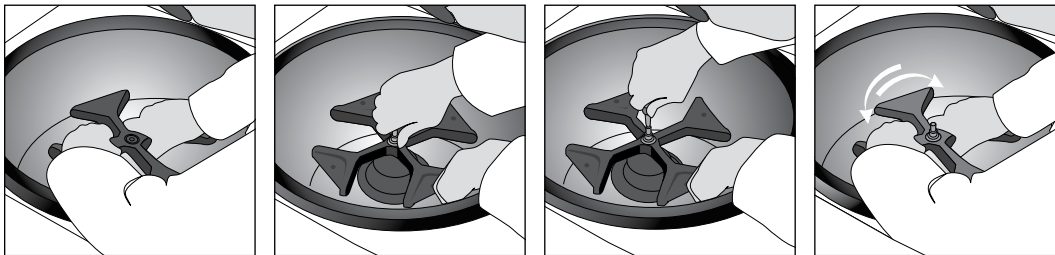

- 1. Place rotor
- 2. Manually tighten
- 3. Secure with tool
- 4. Confirm locked down

◀ Reverse ALL steps to remove rotor

**Auto-Lock Rotor Exchange**

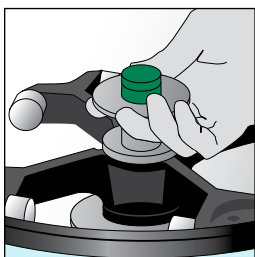

◀ Push center button to remove rotor

- 1. Place rotor with confidence that it is securely locked and will not loosen during a run

**Push-button security and application flexibility**

In a shared laboratory setting with multiple users and a variety of processing requirements, or where bench space is at a premium, Auto-Lock Rotor Exchange provides the flexibility to quickly swap between your sample preparation protocols, from 0.2 mL through 1 Liter, all with the same versatile centrifuge. The easy and reliable push-button Auto-Lock Rotor Exchange system replaces the need for tools to bolt down the rotor, shortening run set-up time. Also, as the rotor automatically and securely locks itself to the centrifuge, the need for hand-tightening is eliminated, improving safety and confidence that the rotor will not loosen during a run.

**Routine cleaning made easy**

Centrifuge chambers can harbor microscopic contamination from the environment and from spilled samples. To ensure a healthy working environment and prevent contamination, laboratories require that the centrifuge chamber is cleaned and disinfected regularly. Auto-Lock Rotor Exchange allows removal of the rotor in only 3 seconds, providing quick and easy access to the centrifuge chamber for the routine cleaning. And once cleaned, the rotor can be securely locked in place again in only 3 seconds.

**Summary**

Thermo Scientific Auto-Lock Rotor Exchange delivers secure, trouble-free rotor installation and removal, easy routine cleaning for safe sample processing and 3-second rotor exchange to simplify performance and evolve with the changing needs of your laboratory.

Experience Auto-Lock Rotor Exchange at [thermofisher.com/benchttopcentrifuges](http://thermofisher.com/benchttopcentrifuges)